

FRED KELLY STADIUM Master Plan



Building Connections to the Future...



HARLEY ELLIS DEVEREAUX



HISTORY OF FRED KELLY STADIUM

Orange Unified School District's Fred Kelly Stadium next to El Modena High School was rededicated on June 11, 2005. An artificial infield and all weather track were installed at the stadium with a combination of funds, which included the Community Foundation of Orange.

The stadium was originally built in 1969 and was named after Fred Kelly who attended Orange Union High School and won an Olympic Gold Medal in the 110-meter high hurdles in the 1912 games. He was also USC's first Olympic Gold Medalist.



Acknowledgement of the Participants

DISTRICT AND HIGH SCHOOL ADMINISTRATIVE STAFF and FACULTY LEADERS

Mike Christensen - *Superintendent of Schools*

Joe Sorrera - *Assistant Superintendent Business Services*

Gary Slump - *Program Manager, Parsons*

Kerrie Torres - *Executive Director Secondary Education*

Dustin Saxton - *Principal, El Modena High School*

Brent McKee - *Assistant Principal, El Modena High School*

Steve Bernard - *Athletic Director, El Modena High School*

Kimberly Fricker - *Principal, Canyon High School*

Pat Bendzick- *Athletic Director, Canyon High School*

Ed Howard - *Principal, Villa Park High School*

Tom Fox - *Athletic Director, Villa Park High School*

Ernesto Gonzales - *Principal, Orange High School*

Sheryl Anderson - *Athletic Director, Orange High School*

SITE LOCATION

Spring

North Prospect

El Modena High School

Fred Kelly Stadium

East Chapman



EXISTING CONDITIONS



- Study indicates Aging Concrete Bleachers (1969) Reaching End of Useful Structural Life
- ADA Accessibility would require Significant Intervention
- Support Buildings are Aging and Inadequate
- Inadequate Facilities for Visiting Teams
- Unattractive Entrance and Inconvenient Drop-Off
- Office of Civil Rights Complaint

EXISTING CONDITIONS

DETERIORATING BERM



EXISTING CONDITIONS

LACK OF ADA ACCESS



EXISTING CONDITIONS



LACK OF ADA ACCESS



EXISTING CONDITIONS



INADEQUATE ENTRIES



EXISTING CONDITIONS



OUTDATED AMENITIES



EXISTING CONDITIONS



INADEQUATE SUPPORT SPACES



PROCESS

- Testing Options
- Prototype Components
- Pre-engineered Stadium Seating Prototypes



FRED KELLY STADIUM - OPTION I

GENERAL UPGRADES

1. STADIUM LIGHTING UPGRADE
2. SOUND SYSTEM UPGRADE
3. ADD ELECTRONIC TIMING SYSTEM FOR TRACK EVENTS
4. UPGRADE ELECTRICAL CAPACITY
5. REMOVE HANDBALL COURTS

MANDATORY UPGRADES

- ACCESSIBLE PARKING
- PASSENGER LOADING
- ACCESSIBLE ENTRY
- ACCESSIBLE WATER FOUNTAIN
- ACCESSIBLE MEN'S & WOMEN'S TOILET ROOMS
- ACCESSIBLE HOME & VISITOR BEACHERS
- ACCESSIBLE PRESS BOX (FIELD LEVEL & RAMPED)
- ACCESSIBLE PATH OF TRAVEL TO PARKING & CAMPUS
- ACCESSIBLE SIGNAGE

ADDITIONS & RENOVATIONS

- RENOVATED TOILET ROOMS
- RENOVATED CONCESSION STAND
- NEW TOILET ROOMS
- NEW TEAM ROOM W/ STORAGE
- NEW ALUMINUM BLEACHERS ON GRADE

PROTOTYPES

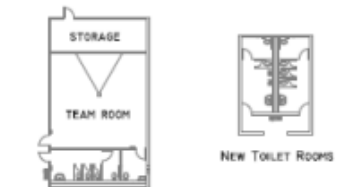

NEW TEAM ROOM W/ STORAGE

PROPOSED MASTER PLAN

OPEN SPACE AND CIRCULATION

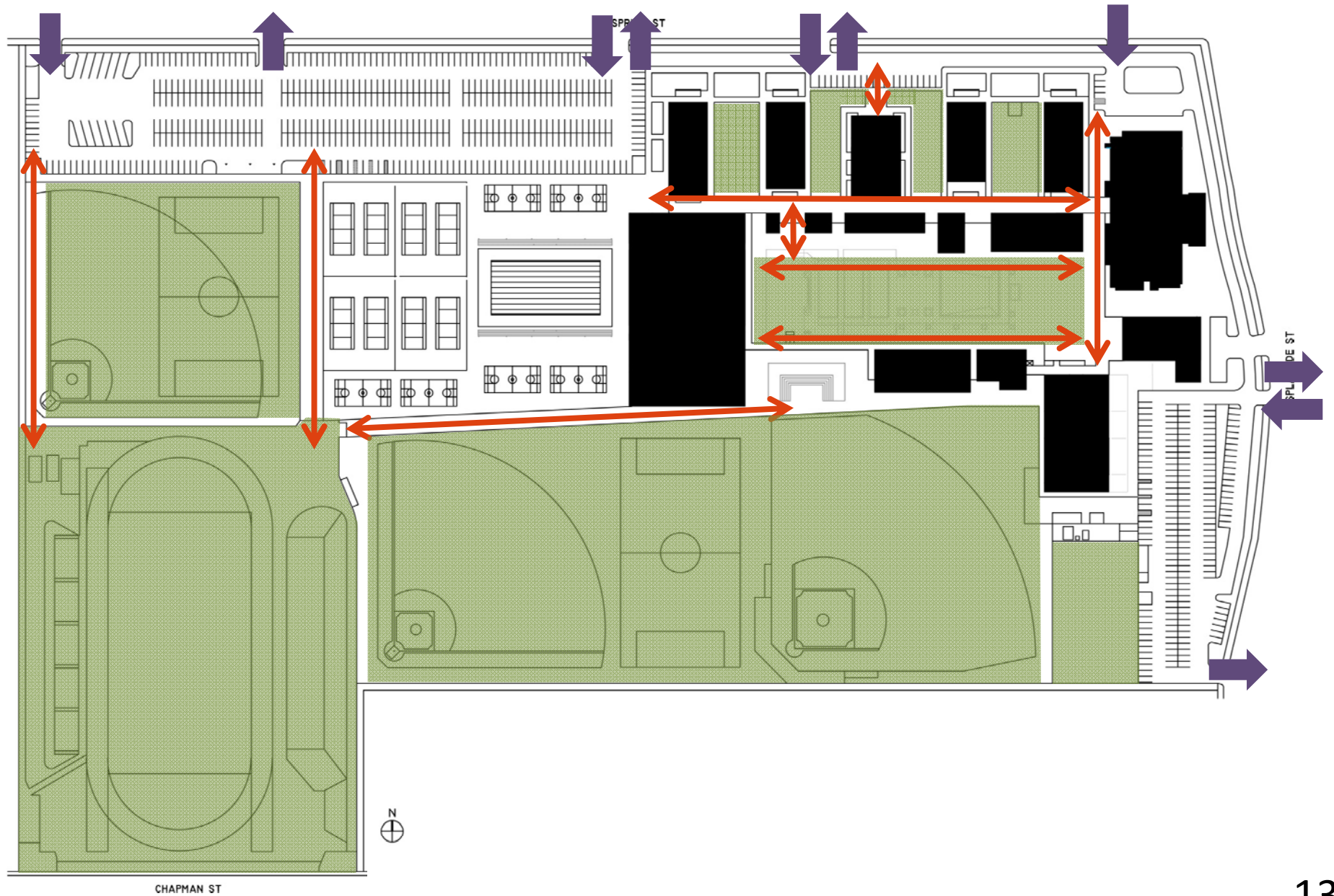

PROPOSED MASTER PLAN

SAFETY & SECURITY



PROPOSED MASTER PLAN

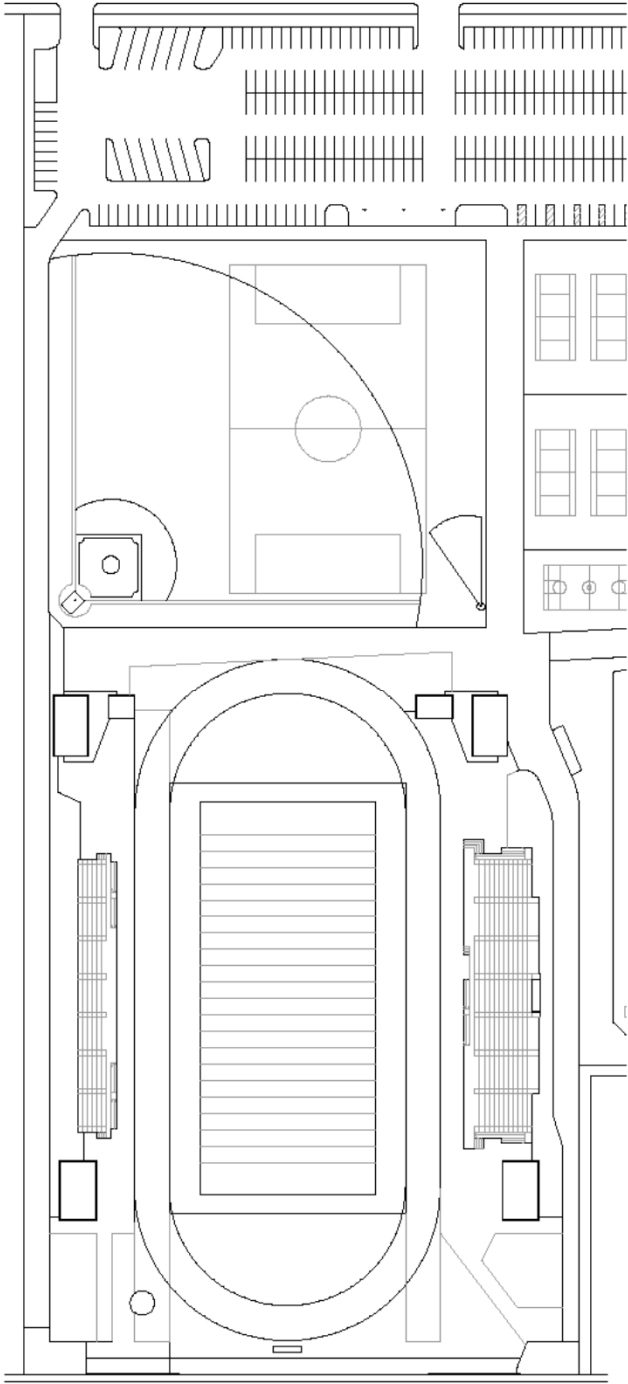

PROPOSED MASTER PLAN

- Re-configure Parking and Drop-Off

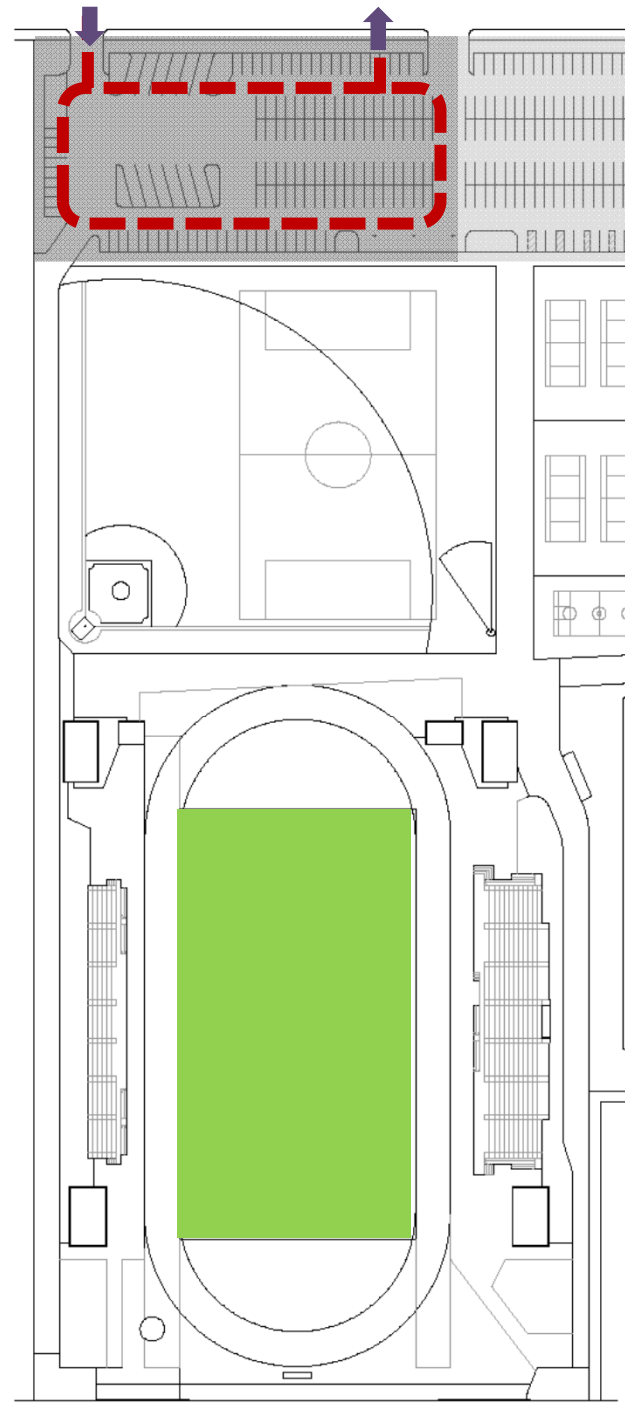

PROPOSED MASTER PLAN

- Re-configure Parking and Drop-Off
- Improve Pedestrian Access

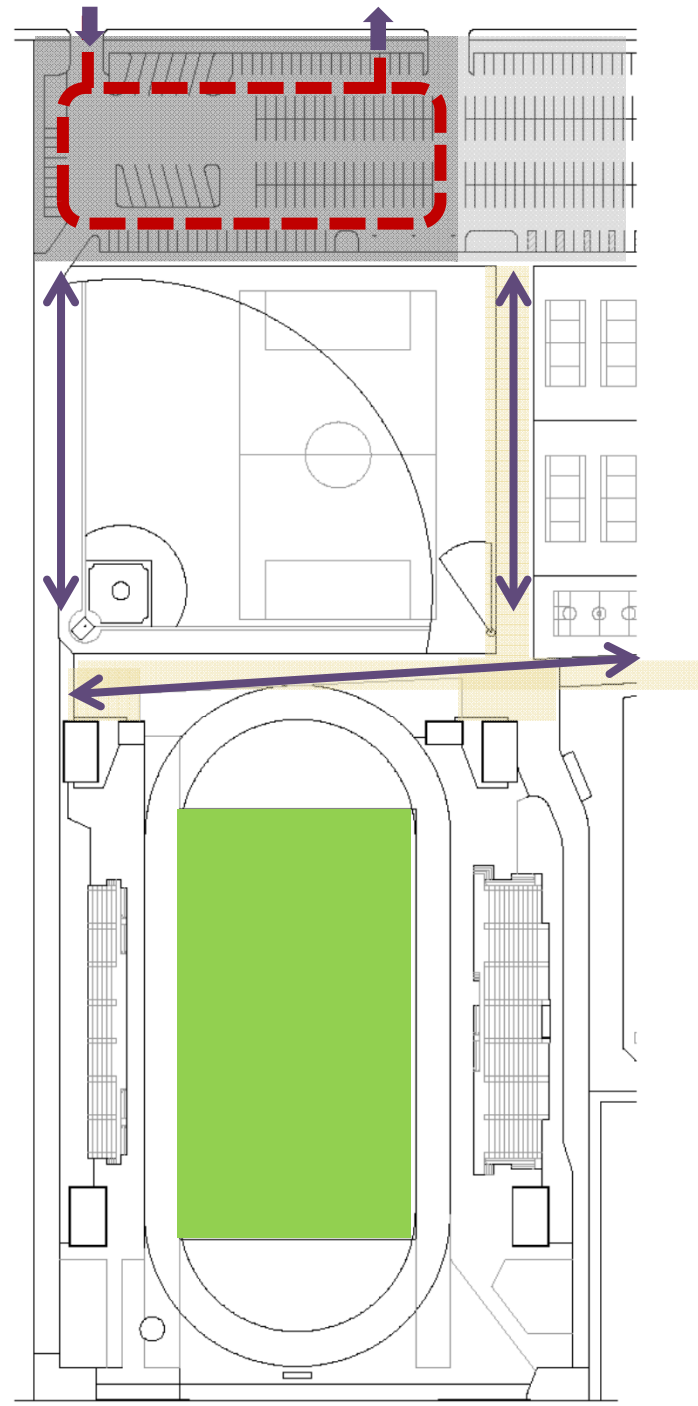

PROPOSED MASTER PLAN

- Re-configure Parking and Drop-Off
- Improve Pedestrian Access
- New Home and Visitor Stadia

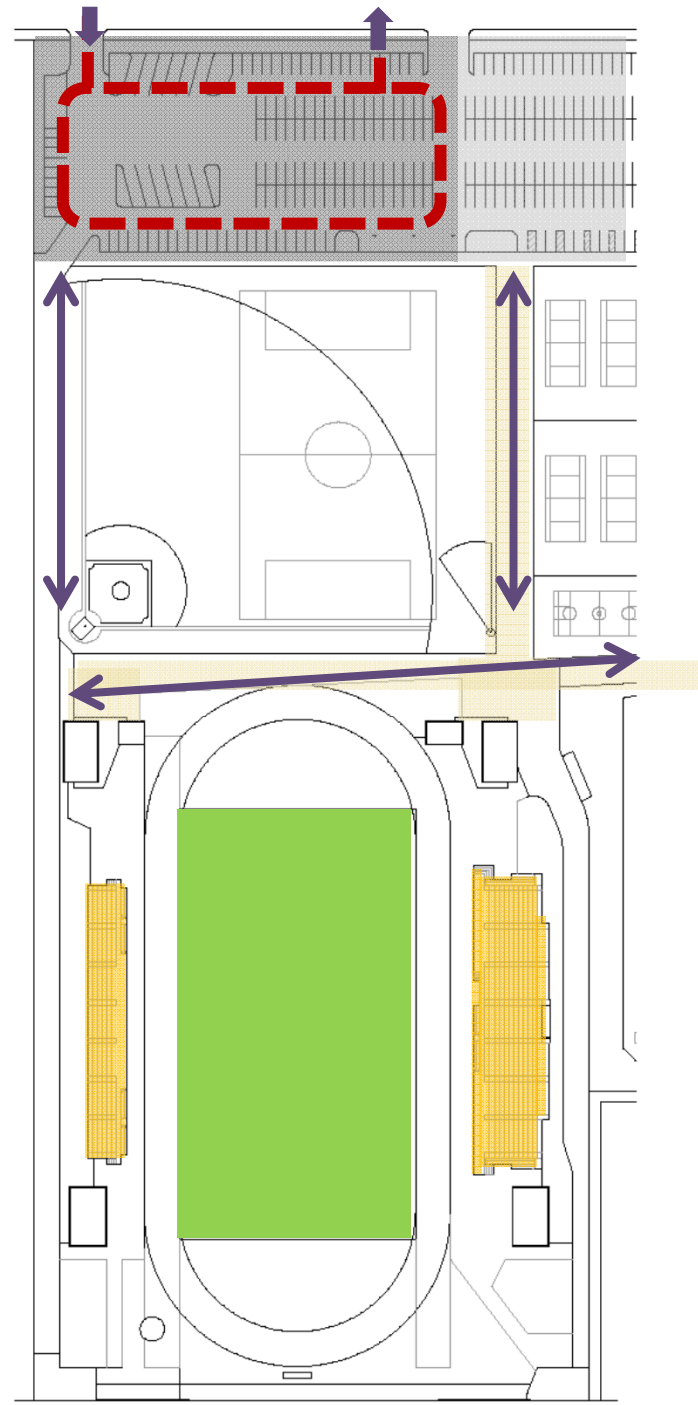

PROPOSED MASTER PLAN

- Re-configure Parking and Drop-Off
- Improve Pedestrian Access
- New Home and Visitor Stadia
- New Team Rooms, Concession Stands, Restrooms and Ticket Booths

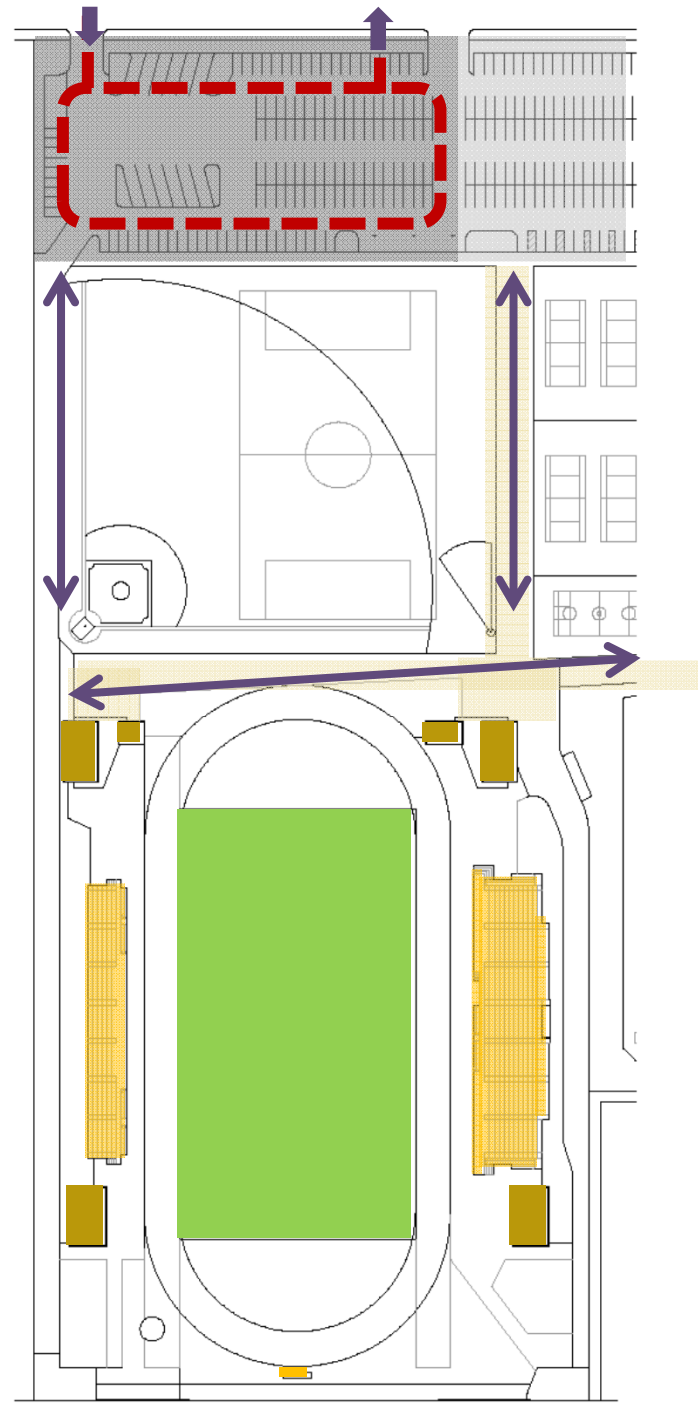

PROPOSED MASTER PLAN

- Re-configure Parking and Drop-Off
- Improve Pedestrian Access
- New Home and Visitor Stadia
- New Team Rooms, Concession Stands, Restrooms and Ticket Booths

Potential El Modena High Projects

- Reconfigure Softball and Practice Field

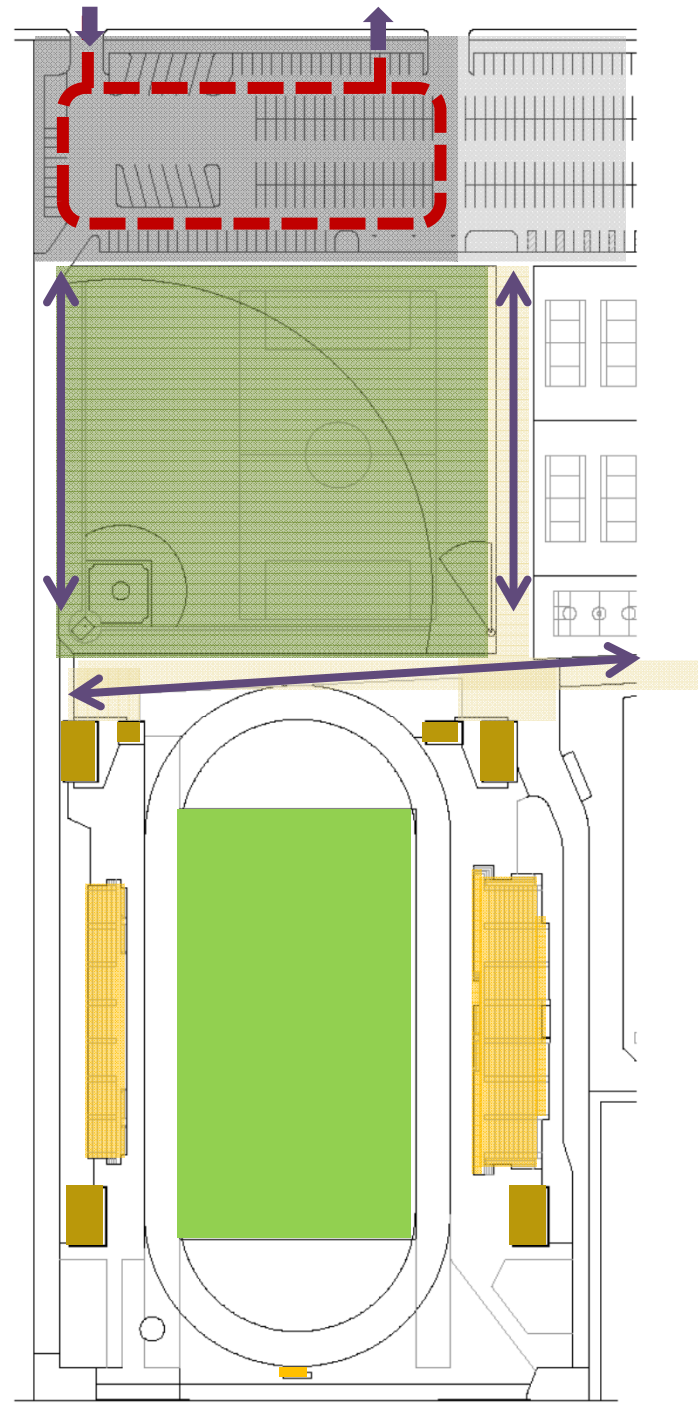

PROPOSED MASTER PLAN

- Re-configure Parking and Drop-Off
- Improve Pedestrian Access
- New Home and Visitor Stadia
- New Team Rooms, Concession Stands, Restrooms and Ticket Booths

Potential El Modena High Projects



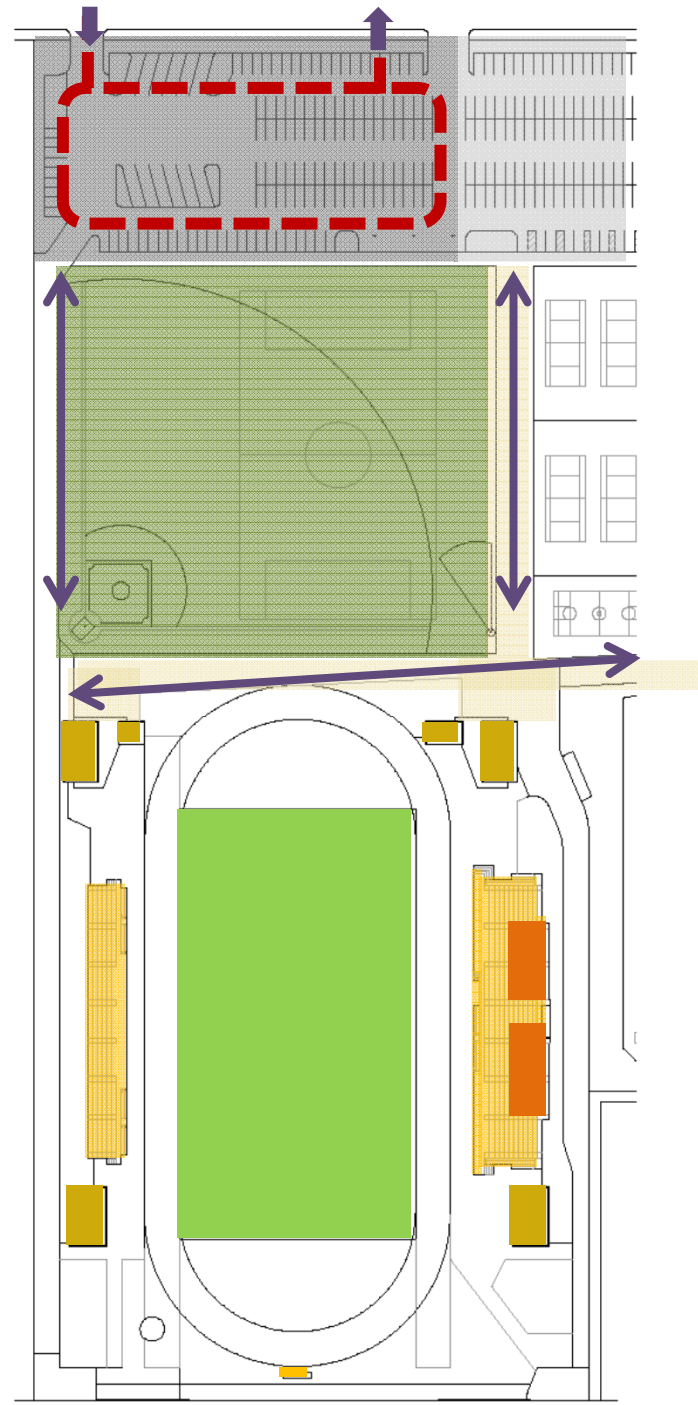



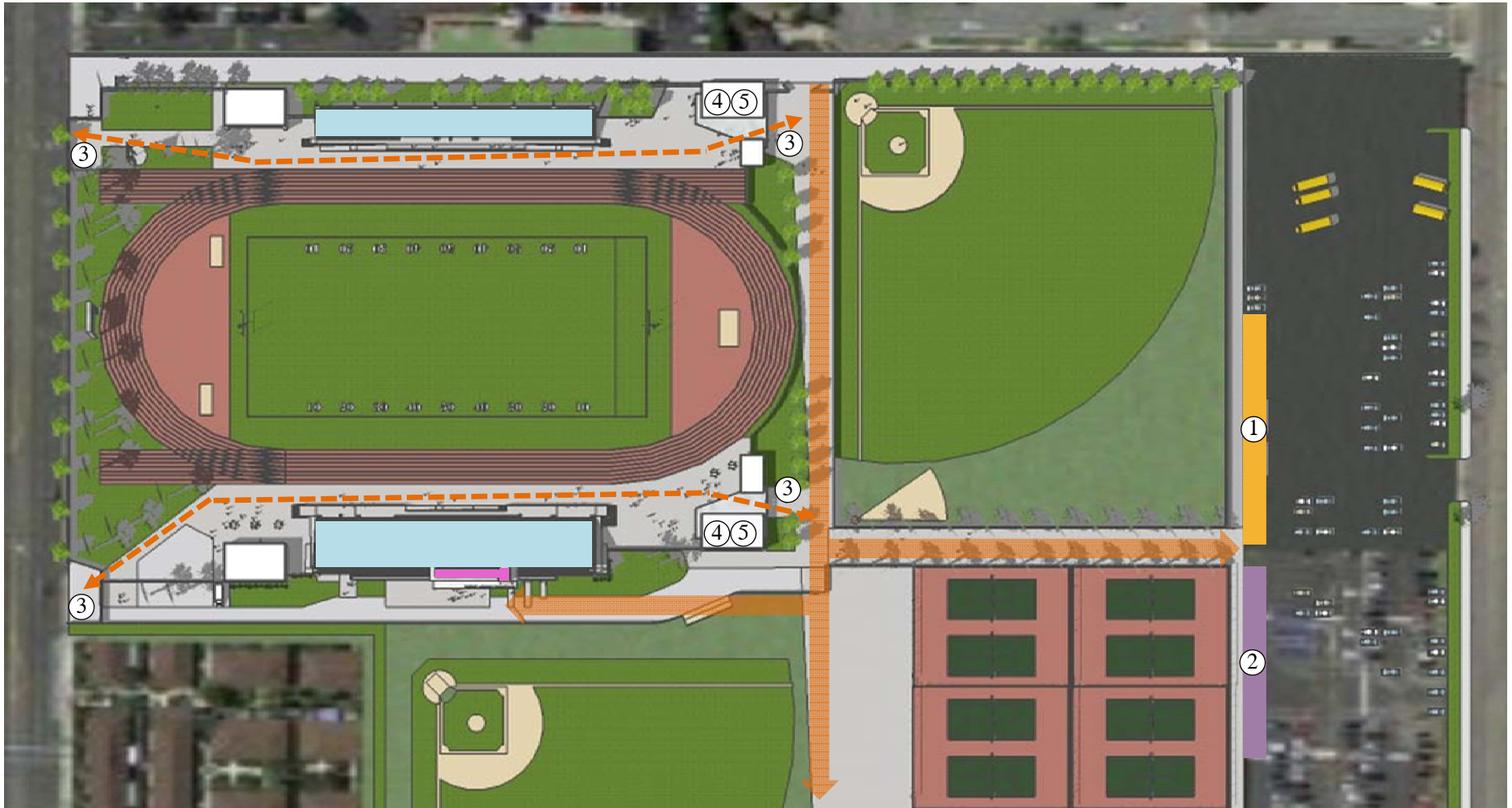

- Reconfigure Softball and Practice Field
- New Weight Room and Storage for El Modena High



OFFICE OF CIVIL RIGHTS RESOLUTION OVERVIEW



Mandatory Upgrades

- | | | | |
|---|---|--|--|
|  | ① Accessible Parking |  | Accessible Home & Visitor Bleachers |
|  | ② Passenger Loading |  | Accessible Press Box (Elevator) |
|  | ③ Accessible Entry |  | Accessible Path of Travel to Parking & Campus Accessible Signage |
|  | ④ Accessible Water Fountain |  | Accessible Path of Travel |
|  | ⑤ Accessible Men's & Women's Toilet Rooms | | |

STADIUM MASTER PLAN OVERVIEW



STADIUM MASTER PLAN OVERVIEW



STADIUM MASTER PLAN OVERVIEW



STADIUM MASTER PLAN OVERVIEW

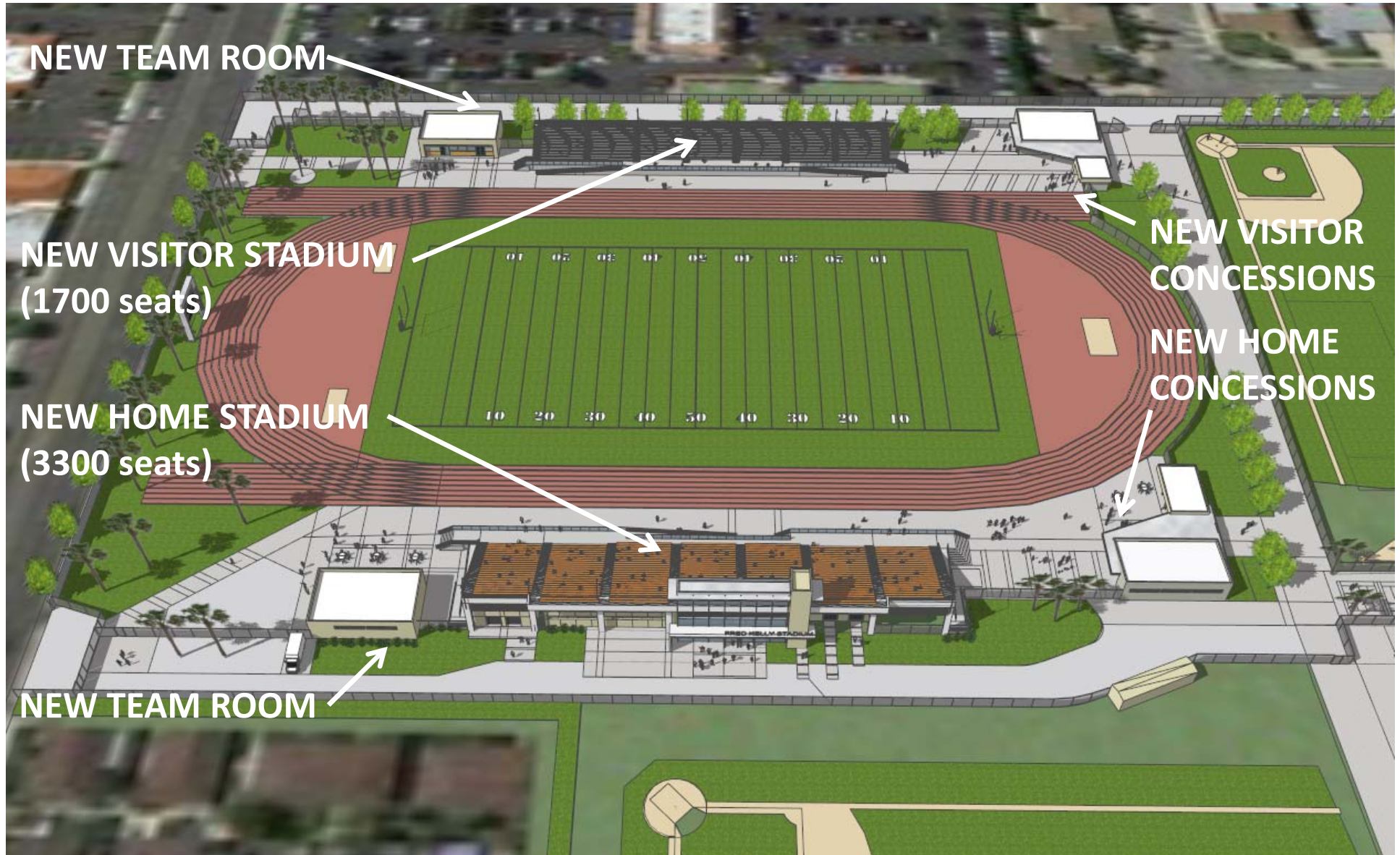

STADIUM MASTER PLAN OVERVIEW



STADIUM MASTER PLAN OVERVIEW



PRELIMINARY COST ESTIMATE

scope of work	quantity	unit	unit cost	total	Remarks
demolition of homeside hill	7,407	cu yd	\$ 15.50	\$ 114,809	
demolition of visitor hill	1,852	cu yd	\$ 15.50	\$ 28,706	
concrete home bleacher demolition	18,000	sf	\$ 3.00	\$ 54,000	
concrete visitor bleacher demolition	11,000	sf	\$ 3.00	\$ 33,000	
new alum bleachers & press box				\$ 3,300,000	allowance
new concessions (2 bldgs)	850	sf	\$ 400.00	\$ 340,000	
new restrooms (2 bldgs)	3,200	sf	\$ 500.00	\$ 1,600,000	
new parking lot	43,700	sf	\$ 10.00	\$ 437,000	
new team rooms (2 bldgs)	3,800	sf	\$ 330.00	\$ 1,254,000	
new ticket booths (4 bldgs)	400	sf	\$ 304.00	\$ 121,600	
new storage rooms	1,300	sf	\$ 244.00	\$ 317,200	
path of travel & hardscape	94,000	sf	\$ 12.00	\$ 1,128,000	
demolition of P.O.T. & hardscape	94,000	sf	\$ 2.30	\$ 216,200	
lighting, sound, scoring & timing systems				\$ 850,000	allowance
site utilities/site electrical				\$ 400,000	allowance
landscaping	57,400	sf	\$ 8.00	\$ 459,200	allowance
Sub-Total				\$ 10,653,715	
General Conditions, OH&P			18%	\$ 1,917,669	
				\$ 12,571,383	
Contingency			10%	\$ 1,257,138	
				\$ 13,828,521	
Bonds			2%	\$ 276,570	
Total Construction Cost				\$ 14,105,092	
Soft Costs			40%	\$ 5,642,037	
Total Project Cost (\$2014)				\$ 19,747,129	

* costing above excludes escalation & haz mat abatement/removal

PROPOSED MASTER PLAN

STADIUM VIRTUAL TOUR



FRED KELLY STADIUM Master Plan



Building Connections to the Future...



HARLEY ELLIS DEVEREAUX

